

Datamate

Female Connectors – PC Tail

- ❖ Fully shrouded contacts.
- ❖ Polarised mouldings.
- ❖ For British Standard versions see page 76.
- ❖ Dummy contacts for additional polarisation use **order code M80-023**.
- ❖ Mates with male connectors on pages 77 to 80.

SINGLE ROW

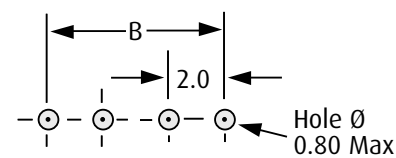
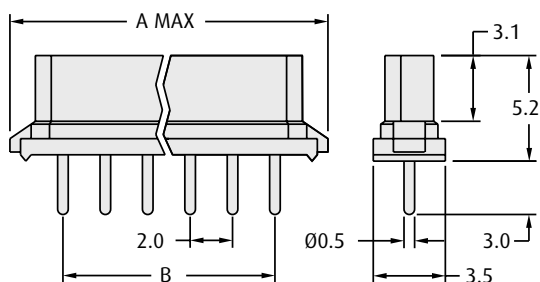

Recommended PC Board Pattern

CALCULATION

A	$B + 5.30$
B	Total No. of contacts – 2

DOUBLE ROW

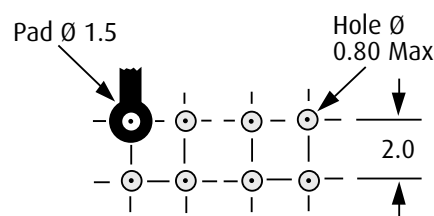
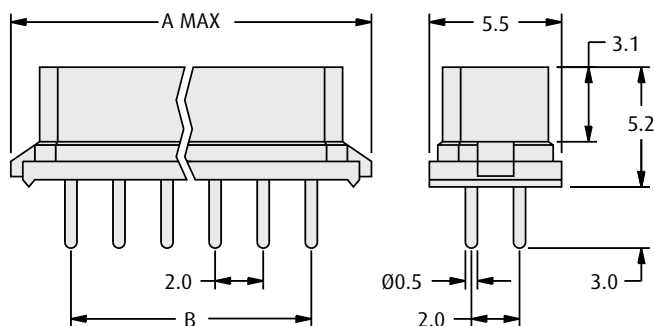

Recommended PC Board Pattern

HOW TO ORDER

M80 - 8 XX XX XX

SERIES CODE

TYPE

87	Double Row
97	Single Row

FINISH

01	Gold + Tin
05	Gold

TOTAL NO. OF CONTACTS

Single Row	02 to 07, 17, 22
Double Row	04, 06, 08, 10, 12, 14, 16, 18, 20, 26, 34, 44

www.harwin.com



HARWIN