

REVISIONS				
SYM	ZONE	ECN, ERN NO.	DATE	APPRD.
D		REVISED PROPOSAL	01/05/31	

THIS IS A CAD DRAWING. DO NOT MANUALLY REVISE.

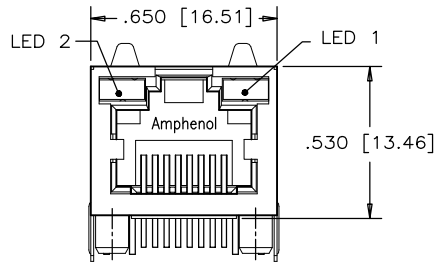

FRONT VIEW

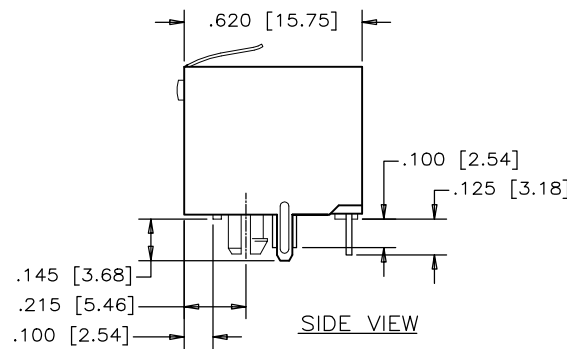

SIDE VIEW

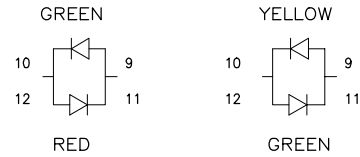

BI-COLOUR LED DETAIL
(RED/YELLOW AND GREEN/ORANGE LED'S ARE ALSO AVAILABLE)

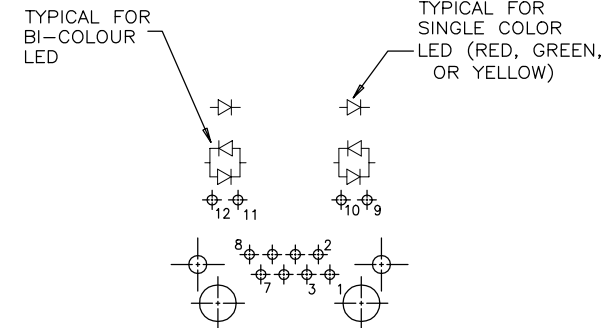

LED SCHEMATIC

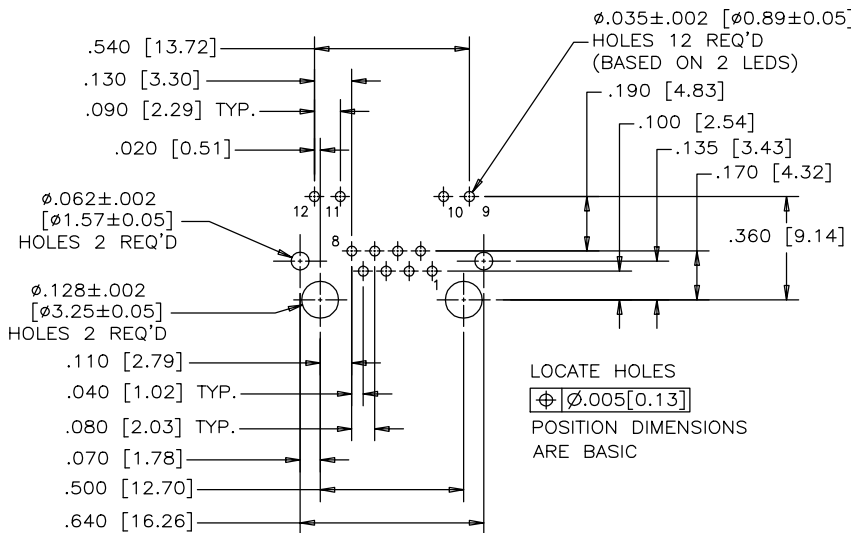

RECOMMENDED P.C.B. LAYOUT
(COMPONENT SIDE OF BOARD)

LOCATE HOLES
Ø .005 [0.13]
POSITION DIMENSIONS
ARE BASIC

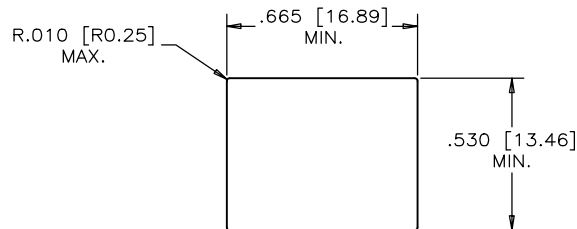

RECOMMENDED PANEL CUTOUT

MATERIALS:

PLASTIC HOUSING: ENGINEERING THERMOPLASTIC
FLAMMABILITY RATING UL 94V-0

CONTACTS:

PHOSPHOR BRONZE
PLATING: 50 µ" [1.27 MICRONS]
MIN. GOLD ON MATING SURFACES.
50 µ" [1.27 MICRONS]
MIN. NICKEL UNDERPLATE
100 µ" [2.54 MICRONS]
MIN. TIN/LEAD ON CONTACT TAILS.

SHIELD:

COPPER ALLOY
PLATING: TIN-LEAD ALLOY

PART NUMBER: RJHS-538X

REFER TO LED OPTIONS DRAWING
FOR ORDERING CODES

DRAWN A.KARIR	DATE 99/11/10	Amphenol Canada Corp.		
DESIGNED				
CHECKED R.PIKE	DATE 99/11/11	TITLE		
I. E. APPRD.		HIGH SPEED, RJ45, MODULAR JACK,		
Q. A. APPRD.		8 POSITION, 8 CONTACTS,		
DWG. APPRD.		SHIELDED, WITH LED's		
ENG. REL. NO.		DWG	DRAWING NO.	REV.
REF.			P-RJHS-538X	D
DIMENSIONS ARE IN INCHES [mm]	CODE ID. NO. 03554	SCALE	WT. -----	SURF. -----
				SHEET 1 OF 1

THIS DOCUMENT CONTAINS PROPRIETARY INFORMATION AND SUCH INFORMATION
MAY NOT BE DISCLOSED TO OTHERS FOR ANY PURPOSE OR USED FOR MANUFACTURING
PURPOSES WITHOUT WRITTEN PERMISSION FROM AMPHENOL CANADA CORP.

REVISIONS			
SYM	ZONE	ECN, ERN NO.	DATE
D		ADDED SPECIFICATIONS	00/06/05

THIS IS A CAD DRAWING. DO NOT MANUALLY REVISE.

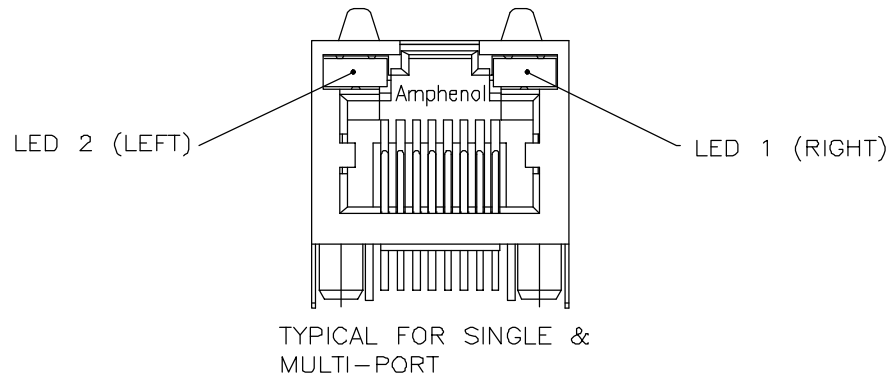

LED SPECIFICATIONS:

FORWARD VOLTAGE: 2.1 VOLTS TYP.

REVERSE VOLTAGE: 5.0 VOLTS MIN.

LUMINOUS INTENSITY: 0.5 mCd MIN.

(AT If=2mA)

STORAGE TEMPERATURE: -20° TO 85° C

LEAD SOLDERING TEMPERATURE: 260° C

(5 SEC, 1/16" FROM CASE)

PLATING ON TAILS: TIN-LEAD (90-10) ALLOY

EXAMPLE:

PART NUMBER RJHS-538X

+ - (ANODE) + - (CATHODE)

LED COLOR CODE

CODE	LED 2 (LEFT)	LED 1 (RIGHT)	CODE	LED 2 (LEFT)	LED 1 (RIGHT)	CODE	LED 2 (LEFT)	LED 1 (RIGHT)
0	BLOCKED	BLOCKED	9	GREEN	BLOCKED	J	BiC RD/GR	YELLOW
1	YELLOW	GREEN	A	BiC GR/YE	BiC GR/YE	K	YELLOW	BiC GR/OR
2	BLOCKED	GREEN	B	BiC RD/GR	BiC RD/GR	L	BiC GR/YE	RED
3	YELLOW	BLOCKED	C	BiC RD/GR	BiC GR/YE	M	RED	YELLOW
4	GREEN	YELLOW	D	GREEN	BiC GR/YE	N	BiC RD/GR	BiC GR/YE
5	GREEN	GREEN	E	YELLOW	BiC GR/YE	P	GREEN	BiC RD/GR
6	YELLOW	YELLOW	F	BiC GR/YE	YELLOW	R	BiC GR/OR	GREEN
7	RED	GREEN	G	BiC GR/OR	BiC GR/OR	T	RED	RED
8	GREEN	RED	H	BiC GR/YE	GREEN	V	BiC RD/GR	GREEN
						W	ADDITIONAL OPTIONS	

PRIMARY COLOR FOR BI-COLOR

LEDs IN STANDARD ANODE/

CATHODE CONFIGURATION IS:

RED-GREEN= RED

RED-YELLOW= RED

GREEN-YELLOW= GREEN

GREEN-ORANGE= GREEN

LEGEND

BiC=BI-COLOR LED

YE=YELLOW

GR=GREEN

RD=RED

OR=ORANGE

EXAMPLE OF ADDITIONAL LED OPTIONS:

PART NUMBER RJHS-538W-01Y

ADDITIONAL LED COLOR CODE

DENOTES ADDITIONAL LED OPTIONS

CODE	LED 2 (LEFT)	LED 1 (RIGHT)	CODE	LED 2 (LEFT)	LED 1 (RIGHT)
0	SEE STANDARD DESIGNATION		4	BLOCKED	RED
1	RED	BLOCKED	5	BLOCKED	YELLOW
2	BiC GR/OR	YELLOW	6	RED	BiC RD/GR
3	YELLOW	RED	7	BiC RD/GR	BiC YL/GR
			8	BiC RD/GR	BLOCKED

NOTE:

THE TWO DIGITS PRECEDING THE ADDITIONAL LED CODE MUST BE USED IN THE PART NUMBER, WHEN ORDERING ANY OF THE ADDITIONAL LED OPTIONS.

DRAWN B. YOUNGSON	DATE 99/09/21	Amphenol Canada Corp.		
DESIGNED				
CHECKED A. KARIR	99/10/25	TITLE LED OPTIONS FOR RJHS, SINGLE OR MULTI-PORT CONNECTORS		
I. E. APPRD.				
G. A. APPRD.		DWG. DRAWING NO. P-RJHS-LEDS		REV. D
DWG. APPRD.				
ENG. REL. NO.		SCALE	WT. -----	SHEET 1 OF 1
REF.		DIMENSIONS ARE IN INCHES [mm]	CODE ID. NO. 03554	

THIS DOCUMENT CONTAINS PROPRIETARY INFORMATION AND SUCH INFORMATION MAY NOT BE DISCLOSED TO OTHERS FOR ANY PURPOSE OR USED FOR MANUFACTURING PURPOSES WITHOUT WRITTEN PERMISSION FROM AMPHENOL CANADA CORP.